

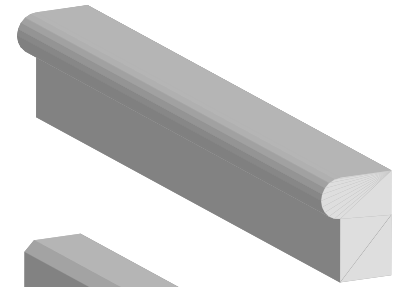

Banding

Item:	Eaton Banding	
Part #	B1E4	B1E5
Height:	7-5/8"	10-1/4"
Thickness:	4"*	4"*
Length:	35-5/8"	35-5/8"

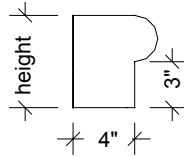

Item:	Shocco Banding	
Part #	B2S4	B2S5
Height:	7-5/8"	10-1/4"
Thickness:	4"*	4"*
Length:	35-5/8"	35-5/8"

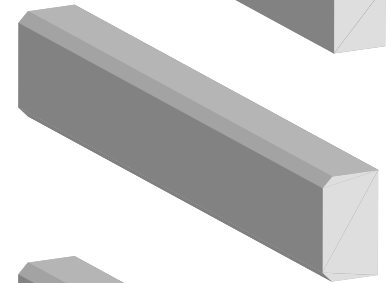
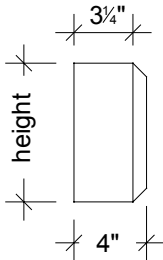

Item:	Polk Banding	
Part #	B3P2	
Height:	3-5/8"	
Thickness:	4-3/8"*	
Length:	35-5/8"	

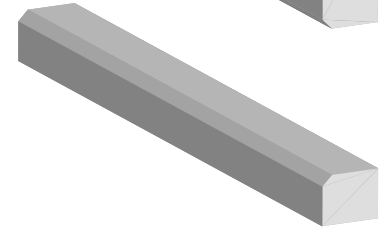
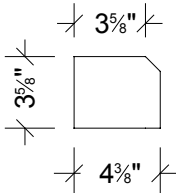

Item:	Vaiden Banding		
Part #	B4V5	B4V6	B4V6
Height:	7-5/8"	10-1/4"	15-5/8"
Thickness:	3-5/8"*	3-5/8"*	3-5/8"*
Length:	35-5/8"	35-5/8"	35-5/8"

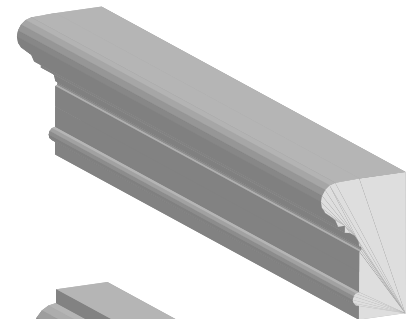
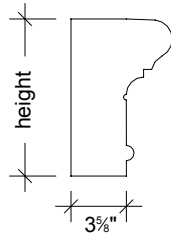

Item:	Saxham Banding	
Part #	B5S4	
Height:	6"	
Thickness:	7-1/2"*	
Length:	35-5/8"	

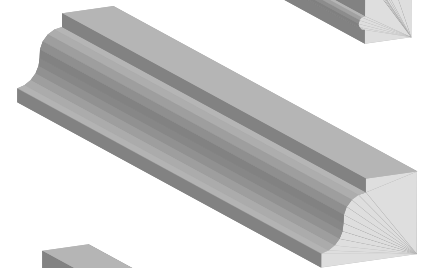
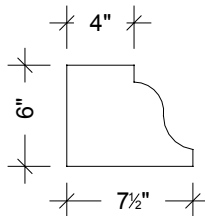

Item:	Jane Banding		
Part #	B6S4	B6S5	B6S6
Height:	7-5/8"	10-1/4"	15-5/8"
Thickness:	3-5/8"	3-5/8"	3-5/8"
Length:	35-5/8"	35-5/8"	35-5/8"

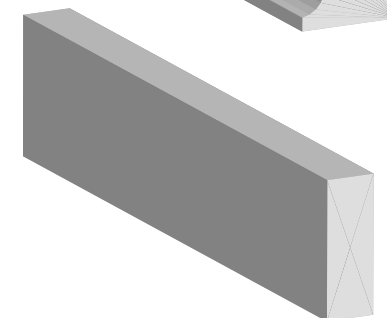
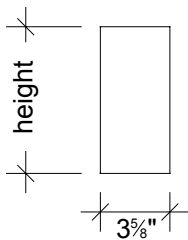

*For returns add L for Left conditions and R for right conditions to the end of corresponding part numbers.*